

Highlights

NAPA® Echlin® offers more than 1,500 critical EVAP Components for import and domestic applications

NAPA® Echlin® also offers more than 4,000 products for crankcase and exhaust gas recirculation (EGR) emissions

NAPA® Echlin's Emissions Components are precision engineered and tested for durability and OE-matching performance

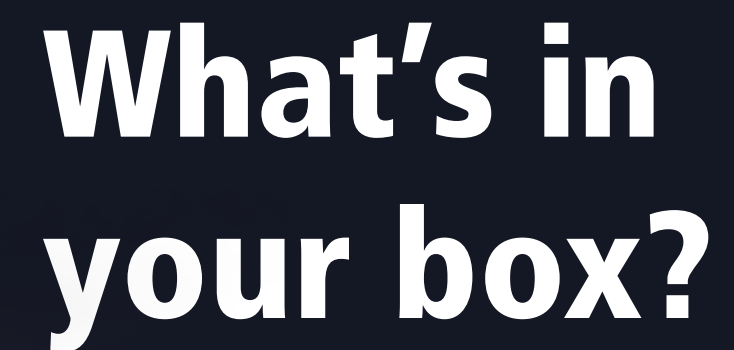

NAPA® ECHLIN® EMISSION CONTROL PROGRAM

Growing Market

It is estimated that the U.S. is responsible for more than 50% of global vehicle emissions. In 2021, the Environmental Protection Agency (EPA) finalized new vehicle emission standards to help further reduce greenhouse gas emissions.

New legislation will have little impact if the vehicles already on the road are not maintained correctly. Keeping your customers' vehicles' emissions low by maintaining the emissions control system with premium components is good business, good for the planet and may help limit future legislation.

STATES THAT REQUIRE EMISSIONS TESTING

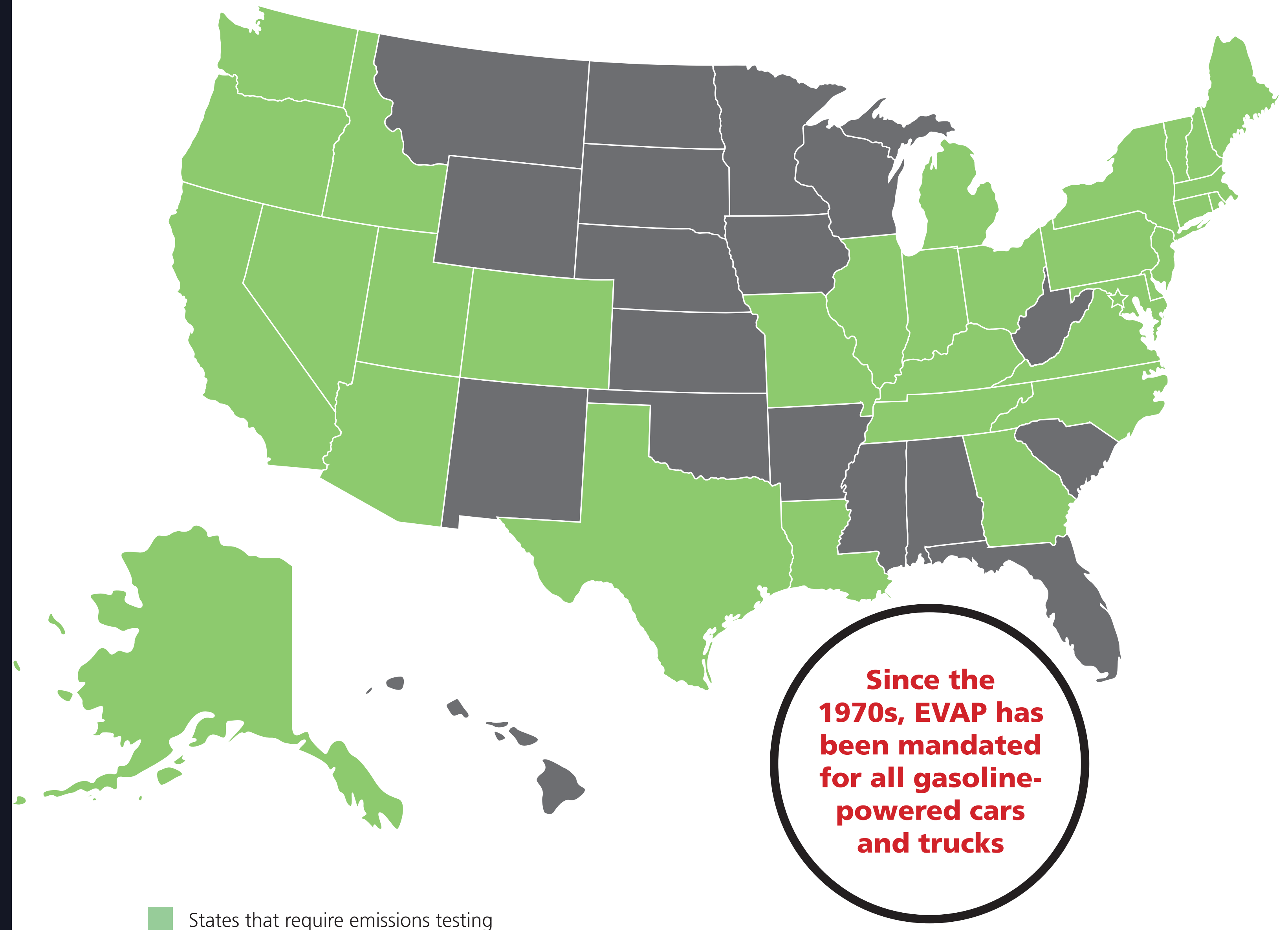

Source: SMP Internal Data, Lucintel Market Reports

NAPA® ECHLIN® EMISSION CONTROL PROGRAM

Sales Opportunities

There are many service repair opportunities within emissions systems.

The 2010-04 Ford Explorer utilizes a mechanical-style EGR valve, which includes the control solenoid and differential pressure feedback-exhaust (DPFE) sensor in one piece. EGR valves like this commonly fail due to ice buildup in the valve, causing cracks in the housing. Additionally, a restricted catalytic converter can cause the assembly to melt and disconnect.

2-26714
Ford / Mercury
(2010–04)

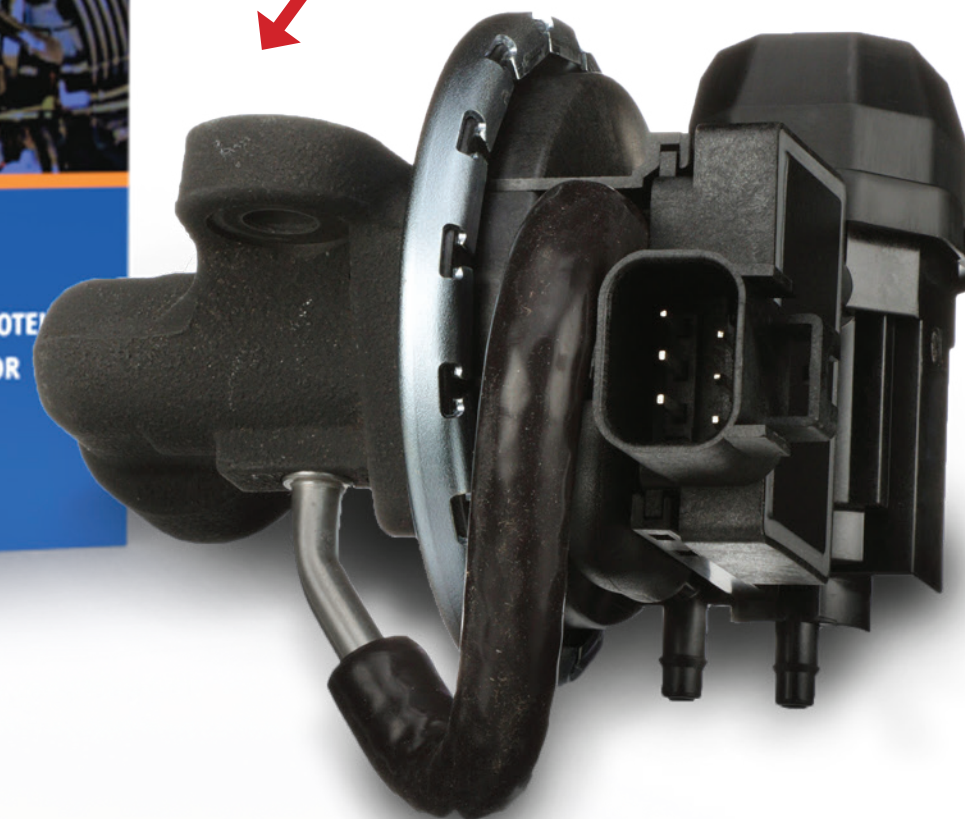

The NAPA® Echlin® 2-26714 is a direct-fit replacement for the original, offering long-lasting durability

Tech Tip

The steel gasket used to mount the EGR valve to the intake manifold has a pre-calibrated orifice. Do not try to modify it or trouble codes will be set.

**NAPA® ECHLIN® EMISSION
CONTROL PROGRAM**

Impact on Engine Systems



A purge solenoid that becomes stuck in the open position will cause the engine to continuously draw fuel vapors from the EVAP system, causing the engine to run rich



When a PCV system isn't operating properly, the crankcase of the engine will be under excessive pressure and cause oil leaks

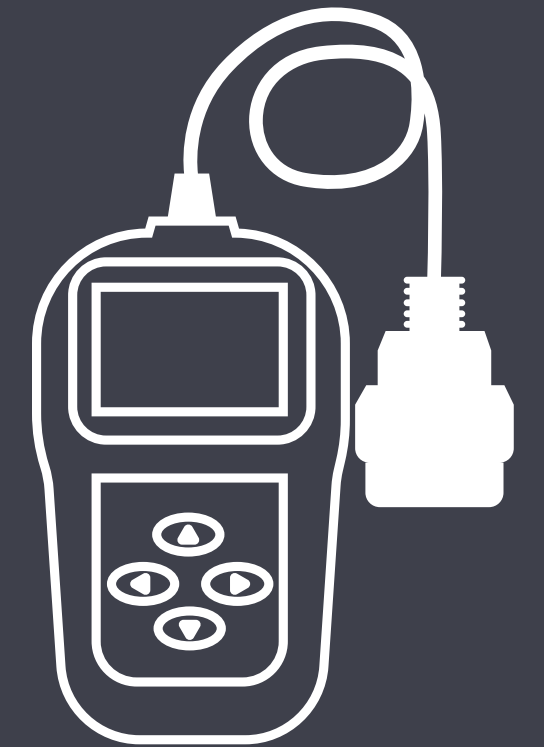

If an EGR valve is stuck open on a speed-density system which uses a MAP sensor for fuel control, the engine vacuum will be lower and engine load will appear higher, resulting in a rich running condition

NAPA® ECHLIN® EVAP

Overview

EVAP is short for Evaporative Emission Control System, which is used to prevent gasoline vapors from escaping into the atmosphere.

NAPA® Echlin® offers a wide range of EVAP components to keep this complex system operating as designed.



Canister Purge Valves

Designed to look, fit, and perform exactly like the original part they're replacing

130+ SKUs / 59M VIO



Canister Vent Solenoids

Includes a premium molding for durability, and 100% tested to match OE design and performance

160+ SKUs / 145M VIO



Canister Vent Valves

Tested to ensure correct performance and manufactured using the highest quality materials to withstand extreme conditions

20+ SKUs / 22M VIO



Canister Purge Solenoids

Designed to look, fit, and perform exactly like the original part they're replacing

350+ SKUs / 215M VIO

NAPA® ECHLIN® EVAP

Overview

NAPA® Echlin® EVAP components are designed to match the OE for form, fit, and critical function. Each part is manufactured to meet stringent standards for quality and durability.

It is important that these parts fit and perform exactly the same as the vehicle manufacturer intended to help keep emissions low.



Fuel Vapor Canisters

Built from industrial grade materials for OE-matching performance and a long service life

600+ SKUs / 248M VIO



ESIM (Evaporative System Integrity Module)

A key component of the EVAP system, this module detects pressure differences across a variety of conditions

4 SKUs / 20M VIO



Leak Detection Pumps

A full line of direct-fit pumps engineered to match OE designed performance

70+ SKUs / 40M VIO

NAPA® ECHLIN® EVAP

What's New

EVAP components account for more than 1,500 part numbers in NAPA® Echlin's ever-expanding line of emissions component coverage.

For the most recent applications, check the online catalog at NAPAEchlin.com.



2-33014
Vapor Canister Purge Pump
GM Trucks & Cars
2.7L
2023-19
VIO: 163K



2-33006
Canister Purge Solenoid
Hyundai / Kia SUVs
1.6L / 2.0L / 2.4L
2022-16
VIO: 1.5M



2-70595
Fuel Vapor Canister
Ford / Lincoln SUVs
2.0L
2023-18
VIO: 638K



NAPA® ECHLIN® EVAP COMPONENTS

Top Movers

IMPORT APPLICATIONS



2-283735

Canister Purge Solenoid
Lexus / Toyota Trucks, Cars & SUVs
(2018-06)



2-282647

Canister Vent Solenoid
Nissan / Infiniti Cars & SUVs
(2023-03)



2-283660

Canister Purge Solenoid
Hyundai / Kia Cars & SUVs
(2014-06)



2-283684

Canister Purge Solenoid
Audi / VW Cars & SUVs
(2015-98)



2-283756

Canister Purge Solenoid
Honda / Acura Cars & SUVs
(2015-06)



2-283727

Canister Purge Solenoid
GM Cars, Trucks & SUVs
(2020-09)



2-283993

Canister Purge Valve
Ford Cars, Trucks & SUVs
(2023-09)



2-282567

Canister Vent Solenoid
GM Trucks & SUVs
(2011-03)



2-284016

Canister Purge Valve
GM Cars & SUVs
(2023-12)



2-71013

Fuel Vapor Leak Detection Pump
Chrysler, Dodge, Jeep & RAM
(2021-07)

DOMESTIC APPLICATIONS

NAPA® ECHLIN® EVAP

Precision Engineering

NAPA® Echlin® delivers long-lasting EVAP components, and all NAPA® Echlin® EVAP parts are rigorously tested to ensure flawless operation. On vehicle-performance matches OE.

The NAPA® Echlin® 2-71013 Evaporative System Integrity Module is built to match the OE part for fit, form, and function, with OE-matching performance.

NAPA® Echlin® Evaporative System Integrity Module

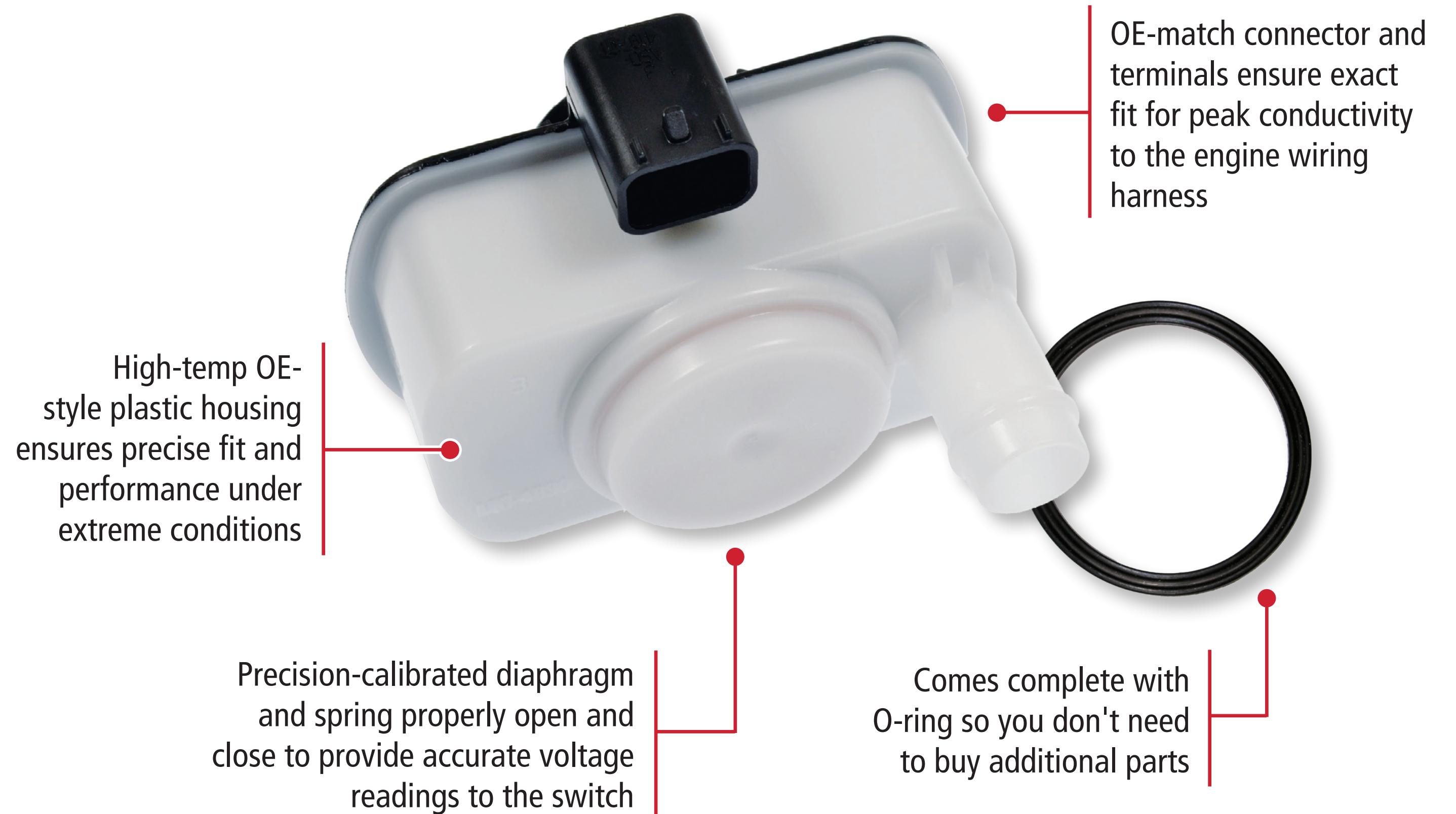

2-71013

Chrysler / Dodge / Jeep / Ram
(2022-07)

NAPA® ECHLIN® CRANKCASE & EGR EMISSIONS

Overview

In addition to an industry-leading EVAP program, NAPA® Echlin® also offers premium products for both crankcase and EGR emissions. Keeping an emission system operating as the vehicle manufacturer intended is critical for performance and fuel economy. All of NAPA® Echlin's emission products are manufactured and tested to keep today's complex emission systems operating correctly.

NAPA® Echlin's Crankcase and EGR Emissions Programs include over 4,000 part numbers. Here is a sampling of the categories included in these programs.



PCV Valves

A component of the crankcase system, these valves control the flow of combustion fumes in ICE engines.

361 SKUs / 199M VIO



PCV Grommets

Designed to look, fit, and perform exactly like the original part they're replacing

130+ SKUs / 59M VIO



Engine Oil Separators

Tested to ensure correct performance and manufactured using the highest quality materials to withstand extreme conditions

20+ SKUs / 22M VIO



EGR Valves

Built from industrial grade materials for durability, and designed as a direct-fit replacement for ease of installation

600+ SKUs / 248M VIO

NAPA® ECHLIN® CRANKCASE & EGR EMISSIONS

Overview

Each Crankcase and EGR component is designed as a direct-fit OE replacement, ensuring that it is easy to install and performs as intended. These parts are also subject to a stringent testing and validation process to ensure durability and a long service life.



Crankcase Breather Hoses

Properly corrects vacuum leaks caused by cracked OE units

40 SKUs / 32M VIO



Crankcase Ventilation Filters

Direct-fit OE replacement for ease of installation, and undergoes extreme testing to ensure reliability

29 SKUs / 6.9M VIO



EGR Control Solenoids

Made with the finest components including multiple precious metal contacts and polymer thick film resistors

63 SKUs / 36M VIO

NAPA® Echlin's offering of EGR Emissions Products also includes:

EGR Delay Valves

EGR Pressure Feedback Hoses

EGR Repair Kits

EGR Time Delay Control Switches

EGR Tubes

EGR Valve Control Solenoid Filters

... and much more

**NAPA® ECHLIN® AND TECH EXPERT®
CRANKCASE & EGR EMISSIONS**

What's New

Crankcase and exhaust emission components account for more than 4,000 part numbers in NAPA® Echlin's ever-expanding line of emission control products.

For the most recent applications, check the online catalog at NAPAEchlin.com.



SEP715
Engine Oil Separator
Ford / Lincoln Cars & SUVs
2.0L
(2018-12)
VIO: 2.1M



2-36041
EGR Valve
Ford Cars, Trucks & SUVs
2.3L
(2023-19)
VIO: 826K



2-9825
PCV Valve
Nissan Cars & SUVs
1.5L / 2.5L
(2023-19)
VIO: 1M



Top Movers

IMPORT APPLICATIONS



2-9651
PCV Valve
Hyundai / Kia Cars & SUVs
(2023-07)



2-26333
EGR Valve
Honda / Acura Cars, Trucks & SUVs
(2010-1997)



2-9541
PCV Valve
Infiniti/Nissan Cars, Trucks & SUVs
(2023-00)



2-9520
PCV Valve
Honda / Acura Cars, Trucks & SUVs
(2019-03)



2-9496
PCV Valve
Hyundai, Kia, & Mitsubishi
Cars & SUVs
(2022-83)

DOMESTIC APPLICATIONS



2-9627
PCV Valve
Chrysler, Dodge, Jeep & Ram
(2020-07)



2-9688
PCV Valve
GM Cars & SUVs
(2023-04)



2-3001
EGR Control Solenoid
Ford Cars, Trucks & SUVs
(2008-1995)



2-9220
PCV Valve
GM Cars, Trucks & SUVs
(2012-1970)



2-26486
EGR Valve
Chrysler, Dodge, Jeep & RAM
(2008-04)

NAPA® ECHLIN® CRANKCASE & EGR EMISSIONS

Precision Engineering

Every NAPA® Echlin® EGR Valve, like the 2-26154, is calibrated for precision performance. To ensure trouble-free operation, each one must pass comprehensive quality testing, including computer-controlled bench testing for resistance, leakage, and response and flow rates.

NAPA® Echlin® EGR Valve

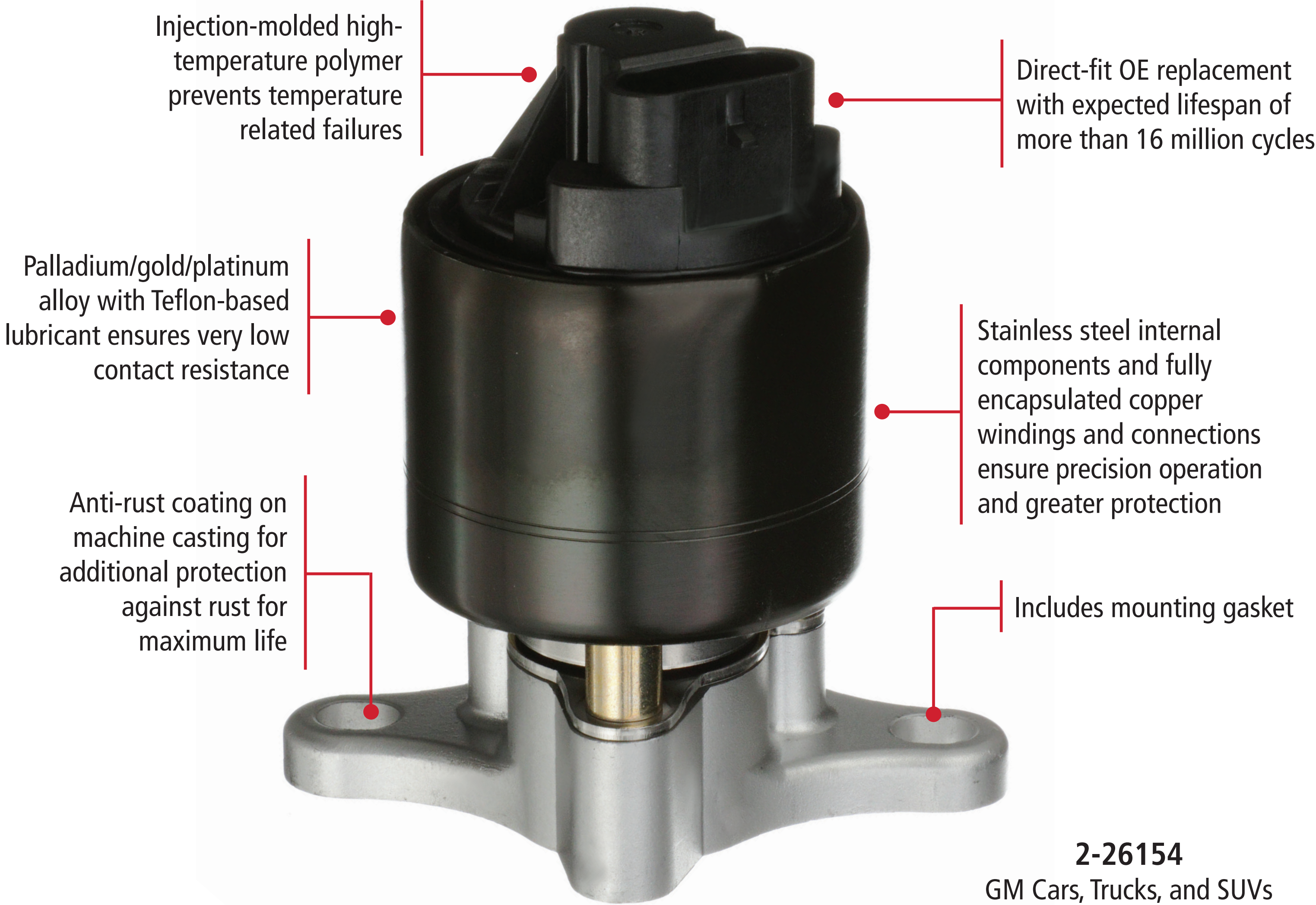

Direct-fit OE replacement with expected lifespan of more than 16 million cycles

Injection-molded high-temperature polymer prevents temperature related failures

Palladium/gold/platinum alloy with Teflon-based lubricant ensures very low contact resistance

Stainless steel internal components and fully encapsulated copper windings and connections ensure precision operation and greater protection

Anti-rust coating on machine casting for additional protection against rust for maximum life

Includes mounting gasket

2-26154
GM Cars, Trucks, and SUVs
(2005–96)

NAPA® ECHLIN®
EMISSION CONTROL PROGRAM

Testing and Validation

Our parts undergo rigorous examination and product validation, including extensive performance benchmarking, product life-cycle testing and end-of-line testing.

Processes can vary from category to category, but it is always thorough. For example, NAPA® Echlin® Canister Purge Solenoids go through a barrage of tests including accelerated wear, thermal cycling, thermal shock, salt fog, vibration, and drop testing.



Emission control products undergo testing and validation at our Independence, Kansas facility.

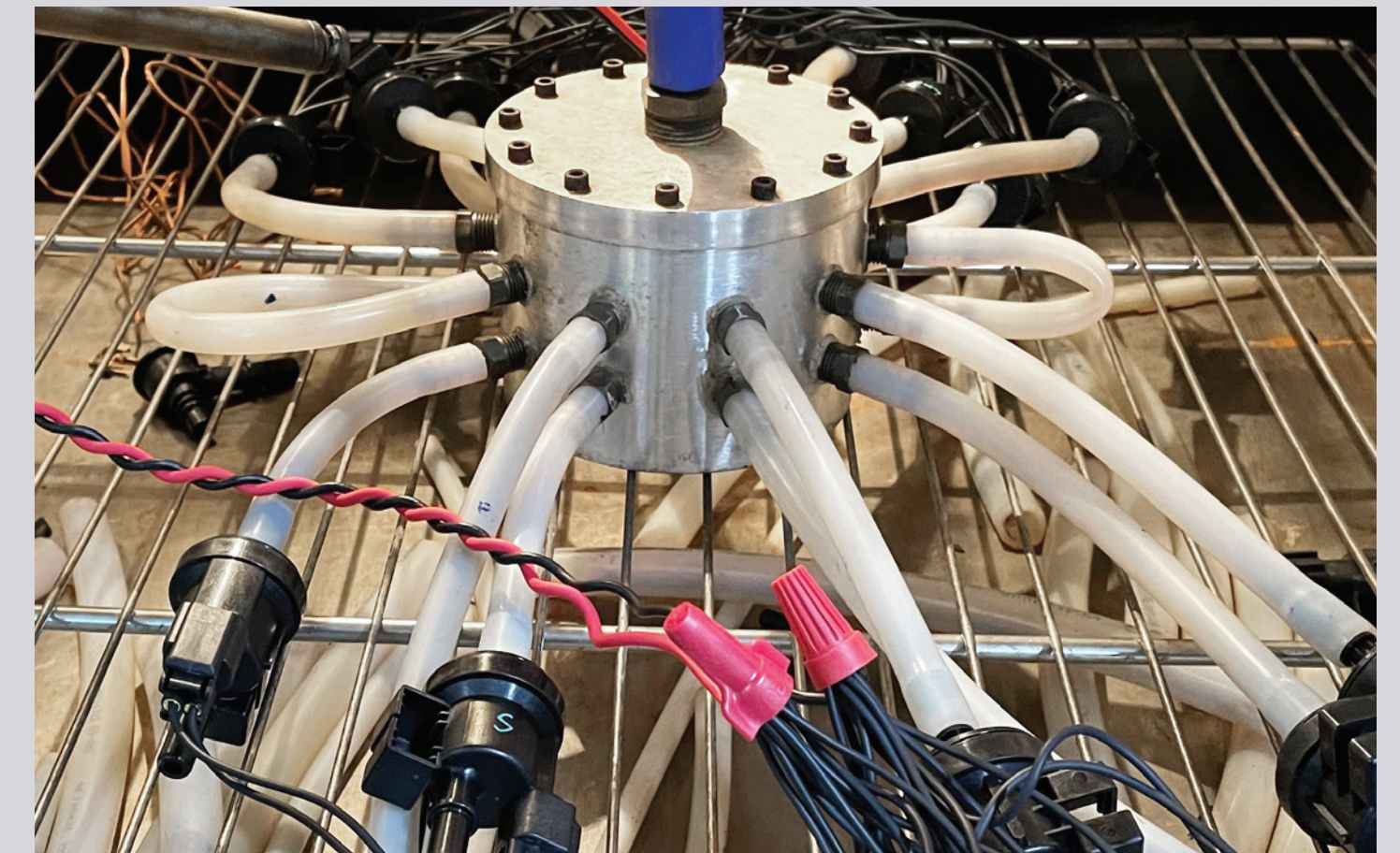
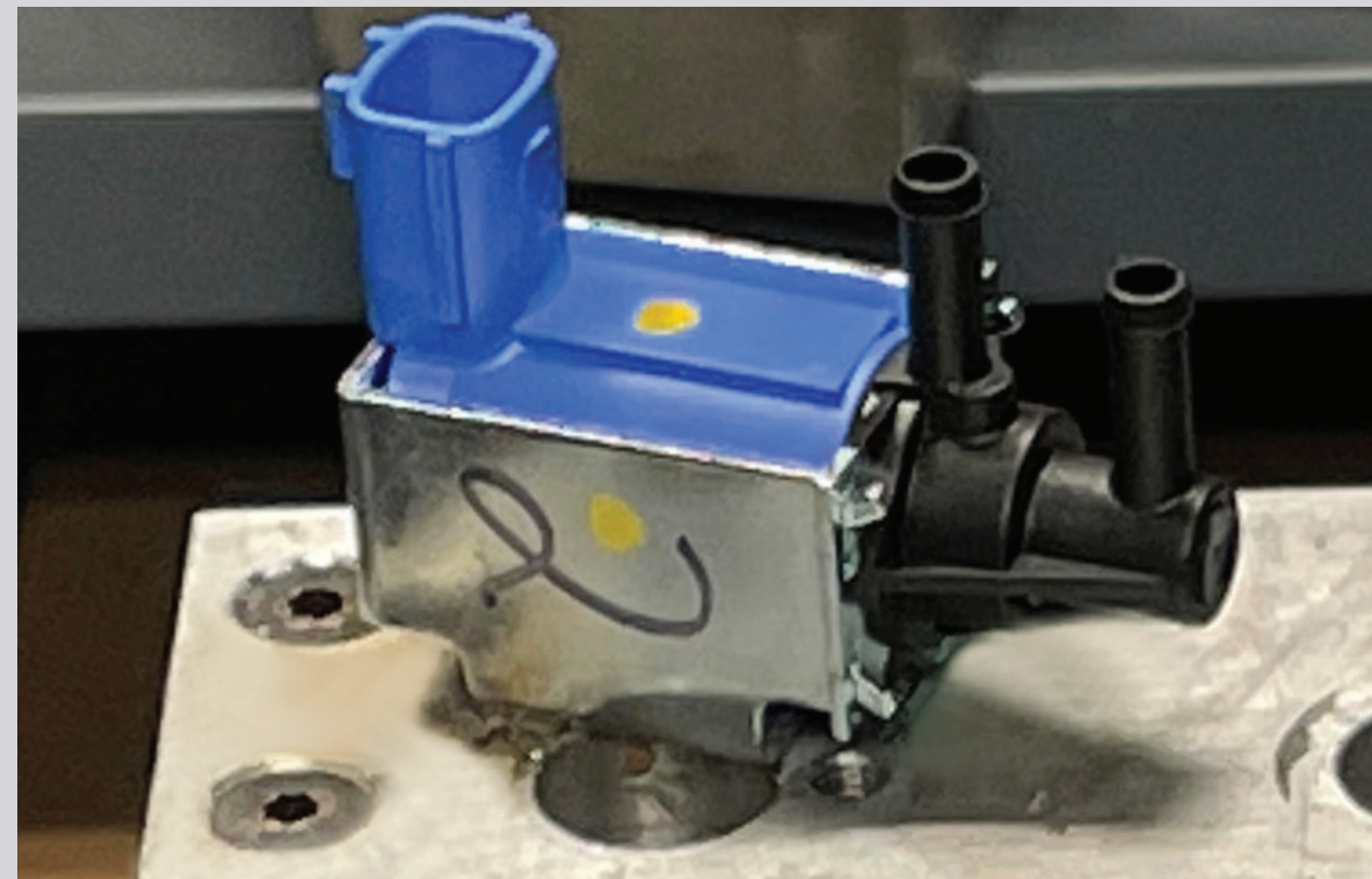

Canister Purge Solenoids are pictured undergoing vibration testing (left) and thermal cycle testing.

NAPA® ECHLIN®
EMISSION CONTROL PROGRAM

NAPA® Echlin®

Training Tech

Tip

As experienced ASE-certified automotive technicians themselves, NAPA® Echlin® Trainers are experts in Emission Control system technology.

Here's what they say to look out for during an Emission Control component install.



After an EVAP system is repaired, it is important to verify the repair by running a self test and verifying that no DTC have returned (this might not be possible for some small EVAP leak codes)



While PCV replacement used to be a part of every tune-up, it has been overlooked on many modern vehicles. In some cases, it will be incorporated into the valve cover. Always check TSBs and see if there is an updated design available, especially if the engine is experiencing oil leaks



EGR low-flow DTCs can be caused by restricted intake passages, fault control solenoids, and faulty EGR valves. Always ensure that the control system is operating properly and that the intake passages are free of carbon build up

NAPA® ECHLIN®
EMISSION CONTROL PROGRAM

NAPA® Echlin® Professional Training

**Award-Winning In-Person, Live
Virtual, and Online Learning**

NAPA® Echlin® Training delivers accredited classes that educate technicians in the latest automotive repair technologies, and techs can earn CEU credits.

An extension of NAPA® Echlin® training, our extensive ADA-compliant YouTube professional video library features more than 500 installation and product videos.



**PRO
TRAINING**
ON-DEMAND

NAPA® Echlin® offers an annual subscription to Pro Training On-Demand. This subscription grants access to more than 200 English, and over 50 Spanish 1-hour courses – and the NAPA® Echlin® on-demand library continues to grow. Topics range from fundamentals to advanced concepts, and include HVAC, diesel, hybrid, ignition, injection, electrical and communication diagnosis.



**PRO
TRAINING**
ON-SITE

Whether in-person at your location or virtually via computer, all NAPA® Echlin® Training classes feature a live instructor and are fully interactive as students work through real-life scenarios. Virtual class “workbooks” include on-demand links to video content and student configurable scan data.

Visit NAPAEchlinTraining.com